

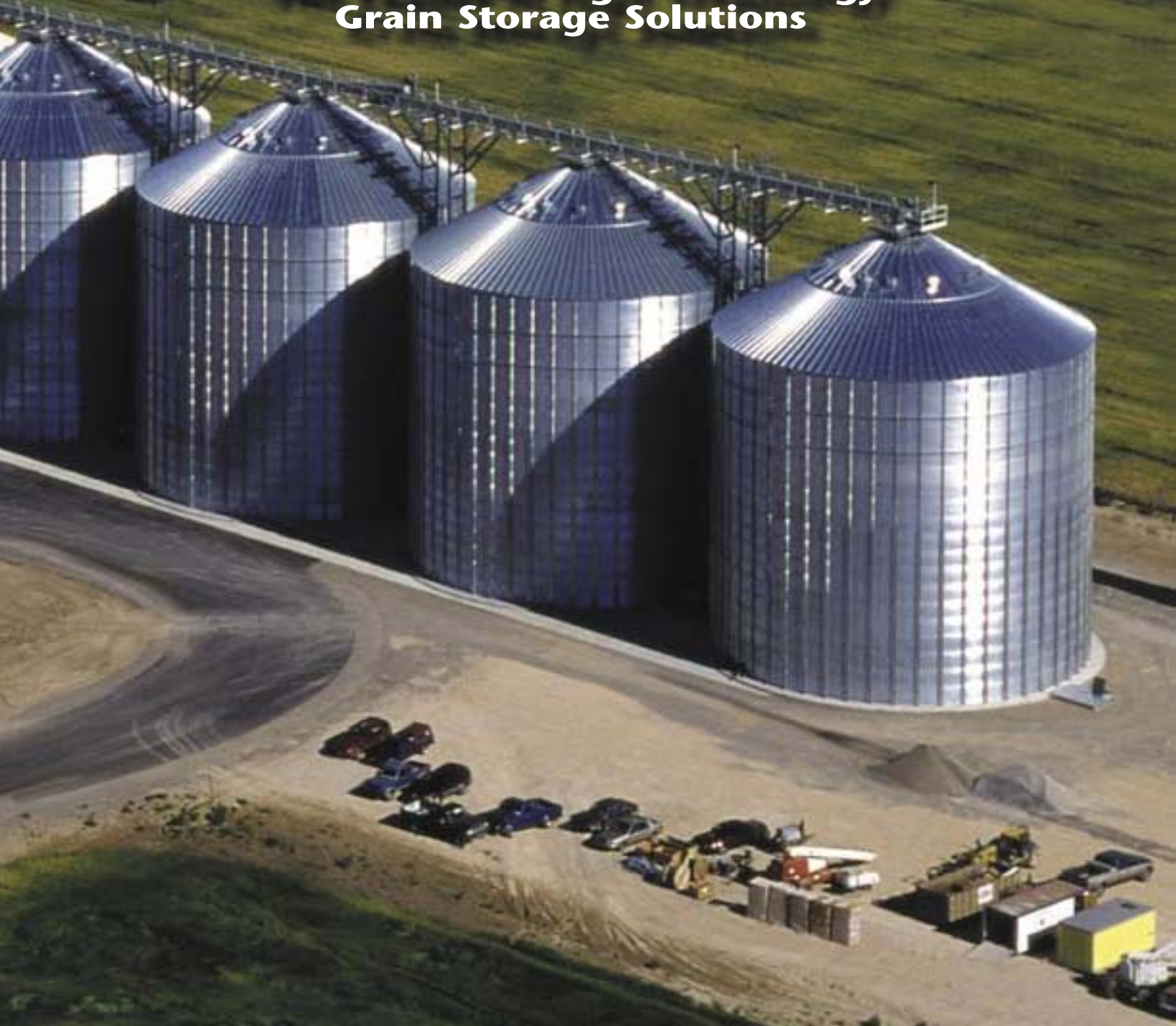

**The Leader in High Technology
Grain Storage Solutions**



Serving Agriculture and Industry Since 1954

GLOBAL STORAGE SOLUTIONS



SCAFCO Grain Systems is a market leader in the design and manufacture of grain storage and handling systems. We enjoy an excellent worldwide reputation for superior system design capabilities, engineering, high-quality materials and craftsmanship.

SCAFCO customers look to us to solve their storage, aeration, conveying, cleaning and drying needs for grain and other flowable bulk commodities. Customers in over fifty-five countries rely on SCAFCO and our full line of stiffened and non-stiffened silos, hopper bottom silos, including a complete line of accessories.

Contact SCAFCO about your handling and storage needs for commodities such as wheat, corn, soybeans, barley, pulses, rice, sunflowers, palm kernels, and other free flowing products like polyethylene resin beads, wood pellets, animal feed and some minerals. Whether your storage requirement is large or small, SCAFCO will provide the design and manufacturing support you need.

CONTENTS

Non-Stiffened Silos	3
Stiffened Silos	5
Hopper Bottom Silos & Specifications	7
Aeration & Drying Systems	9

INSTALLED IN OVER 55 COUNTRIES



AROUND THE WORLD



CONTENTS

Roof Systems	10
Product Engineering	11
Additional Quality Products	12
Silo Specifications	13-14

SCAFCO NON-STIFFENED SILOS

Our non-stiffened silos are perfect for on-farm applications and small silos, ranging from 12' to 48' diameter (3.66 m to 14.63 m).

Our unique 42 2/3" (1.08 m) galvanized steel sheets have a 2 2/3" pitch and 1/2" (67.7 mm x 12.7 mm) deep corrugation that is substantially stronger than the competitors' standard 4" (102 mm) pitch corrugation. Plus, sheets are pre-punched in a single stroke operation, assuring accurate hole alignment and uniform fit. Wall sheets are precision roll-formed from high tensile steel.

SCAFCO non-stiffened silos provide an exceptionally strong storage solution.



CAP & RIB ROOF PANELS

SCAFCO's one piece, deep-rib roof panels provide outstanding load-carrying characteristics, and are durable under heavy snow and ice loads as well as other extreme weather conditions. Our design enables roof systems to bolt together rapidly in the field with each roof panel securely fastened to wall panels with steel clips.

Heavy-duty 3 1/4" (82 mm) high box-ribs provide strength and rigidity for each roof panel. Roofs have either 24 or 36 roof panels – depending upon silo diameter – and a weather-tight closure.



INSPECTION HATCH

Standard on every SCAFCO silo (12' (3.66 m) & larger) roof is a man-sized inspection hatch at the eave, which is weather-tight and factory installed with a lockable latch.

COMPLETE LADDER SYSTEM

SCAFCO provides a complete ladder system inside and outside the silo. Safety cages and rest platforms are also available.



HIGH STRENGTH BOLTS

All SCAFCO Grain Silos are furnished with heat-treated SAE grade 8.2 (DIN 10.9) bolts and JS500 plating that will meet a minimum of 500 hours to red rust in salt spray tests. Compare to other silo manufacturers who use zinc dichromate bolts that can only withstand a minimum of 108 hours to red rust in tests.



WALK-IN DOORS

Available on all farm silos through 48' (14.63 m) diameter and 32' (9.76 m) eave height, SCAFCO's walk-in door opens up to 28" x 60" (710 mm x 1524 mm). The design includes a welded frame, reinforced outer door panel, and three hinged inner flaps with positive locking bars. Door bolts into place easily with corrugated welded door jambs. A Heavy-Duty version is also available for all stiffened silos.



SCAFCO STIFFENED SILOS

SCAFCO commercial grain silos offer many outstanding strength and durability features. Wide corrugated steel sheets manufactured from high strength steel, heavy duty galvanized steel stiffeners and strong box-rib roofs are some of the quality features available.

Our complete line of commercial silos is available in diameters from 15 feet (4.57 m) to 105 feet (32 m). Extra-tall sizes are available in all diameters. SCAFCO also has a full range of accessories available to complete your storage installation.



SUPER STIFFENERS

SCAFCO's super stiffeners utilize 57-ksi yield strength (393 MPa) [65 ksi minimum tensile strength (448 MPa)], hot dip galvanized steel. The shape of the super stiffeners surpasses the compressive strengths of previous open-faced stiffeners. This profile can handle the drawdown loads imposed by very tall silos, as well as severe seismic loads. Each silo utilizes several stiffener gauges and up to three profiles for the most efficient column design.



HEAVY-DUTY STIFFENERS

Heavy-duty stiffeners transfer drawdown loads from the side-walls to foundation. Stiffener base plate is factory-welded to bottom stiffener providing durable silo anchorage to resist lateral and uplift loads.



SIDE DISCHARGE SYSTEM

SCAFCO side discharge system allows gravity loadout to trucks or rail cars. Interior flumes channel grain from top storage level to the discharge chute. Available with 12" (300 mm) square discharge pipe and rack and pinion gate.

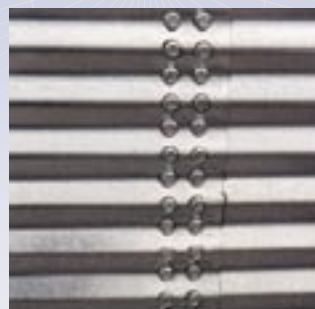

GALVANIZED STEEL WALL SHEETS

Our unique 42 2/3" (1.08 m) galvanized steel wall sheets have a 2 2/3" pitch and 1/2" (6.7 mm x 12.7 mm) deep corrugation. Wall sheets are pre-punched in a single stroke operation, assuring accurate hole alignment and uniform fit. Sheets are precision roll-formed using galvanized steel with a minimum of 57 ksi (393 MPa) yield strength.



COMPLETE LADDER SYSTEMS, ROOF STAIRWAYS & CATWALKS

Complete interior & exterior ladder systems are available including safety cage and rest platforms for sidewall heights above 32' (9.76 m). SCAFCO also provides roof stairways and catwalks for all our grain storage silo systems.



ACCESS DOORS

Stiffened silos feature a heavy-duty 23 1/2" x 26" (597 mm x 660 mm) access door. Access doors are factory-welded into the silo's wall sheets.

Customers may also select from these stiffened-silo door options:

Heavy-duty 28" x 36" (710 mm x 915 mm) utility door.

Heavy-duty Walk-in door for easy access. 28" x 60" (710 mm x 1525 mm)

Giant Doors

"Giant" doors designed for drive-in access for small front-end loaders or other equipment. Two sizes: 67" x 75" or 72" x 96" (1.7 m x 1.9 m or 1.8 m x 2.4 m) are also available.



SCAFCO HOPPER BOTTOM SILOS

If your application requires a complete silo cleanout, or you need lower material handling costs, a SCAFCO hopper bottom silo may be your solution. Our sturdy design and quality materials, including SCAFCO's standard 2 2/3" (67 mm) pitch corrugated steel wall sheets, make our product stronger and more durable than ordinary hopper silos. Plus, we offer a wide range of features and options to provide you with a silo that is custom-made to your application.

SCAFCO supplies hopper bottom silos from 3 tons to over 1000 tons capacity in a wide variety of sizes. Hopper bottom silos can store any flowable commodity from grain, feed, seed and plastic pellets to certain mineral supplements. SCAFCO also supplies structural platforms to elevate silos above rail sidings or truck driveways for rapid loading of railcars or trucks.



SPECIFICATIONS

SILO MODEL NUMBER	DIAMETER (FEET) (METERS)		OVERALL HEIGHT (FEET) (METERS)		VOLUME CAPACITY (CU. FEET) (CU. METERS)		BUSHEL + 5% COMPACTION*	@770 KG/M ³ METRIC TONS
60° HOPPER BOTTOM SILOS - CENTER DISCHARGE								
6601HBT	6'	1.83	12' 1"	3.68	164	4.6	132	3.6
6602HBT	6'	1.83	15' 7"	4.76	263	7.5	212	5.7
6603HBT	6'	1.83	19' 2"	5.84	363	10.3	291	7.9
6604HBT	6'	1.83	22' 9"	6.93	462	13.1	371	10.1
9601HBT	9'	2.74	15' 7"	4.74	439	12.4	353	9.6
9602HBT	9'	2.74	19' 1"	5.82	663	18.8	533	14.4
9603HBT	9'	2.74	22' 8"	6.91	887	25.1	713	19.3
9604HBT	9'	2.74	26' 3"	7.99	1,111	31.5	893	24.2
9605HBT	9'	2.74	29' 9"	9.07	1,335	37.8	1,072	29.1
9606HBT	9'	2.74	33' 4"	10.16	1,558	44.1	1,252	33.9
1201HBT-60	12'	3.66	19' 1"	5.82	907	25.7	729	19.8
1202HBT-60	12'	3.66	22' 8"	6.90	1,305	37.0	1,049	28.4
1203HBT-60	12'	3.66	26' 2"	7.99	1,703	48.2	1,368	37.1
1204HBT-60	12'	3.66	29' 9"	9.07	2,101	59.5	1,688	45.7
1205HBT-60	12'	3.66	33' 4"	10.15	2,499	70.8	2,008	54.4
1501HBT-60	15'	4.57	22' 7"	6.89	1,612	45.7	1,296	35.1
1502HBT-60	15'	4.57	26' 2"	7.97	2,234	63.3	1,795	48.6
1503HBT-60	15'	4.57	29' 9"	9.06	2,856	80.9	2,295	62.2
1504HBT-60	15'	4.57	33' 3"	10.14	3,478	98.5	2,794	75.7
1505HBT-60	15'	4.57	36' 10"	11.23	4,099	116.1	3,294	89.3
1506HBT-60	15'	4.57	40' 5"	12.31	4,721	133.7	3,794	102.8
1507SHBT-60	15'	4.57	44' 1"	13.44	5,343	151.3	4,508	122.1
1508SHBT-60**	15'	4.57	47' 8"	14.53	5,964	168.9	5,032	136.4
1509SHBT-60**	15'	4.57	51' 3"	15.61	6,586	186.5	5,557	150.6
1510SHBT-60**	15'	4.57	54' 9"	16.70	7,208	204.1	6,081	164.8
1511SHBT-60**	15'	4.57	59' 3"	18.05	7,985	226.1	6,737	182.5
1512SHBT-60**	15'	4.57	61' 11"	18.86	8,451	239.3	7,131	193.2
1514SHBT-60**	15'	4.57	67' 0"	20.42	9,345	264.6	7,885	213.6
1804SHBT-60**	18'	5.49	36' 11"	11.24	5,291	149.8	4,464	121.0
1805SHBT-60**	18'	5.49	40' 5"	12.33	6,186	175.2	5,220	141.4
1806SHBT-60**	18'	5.49	44' 0"	13.41	7,082	200.5	5,975	161.9
1807SHBT-60**	18'	5.49	47' 7"	14.50	7,977	225.9	6,730	182.4
1808SHBT-60**	18'	5.49	51' 7"	15.72	8,990	254.6	7,586	205.5
1809SHBT-60**	18'	5.49	55' 2"	16.81	9,886	279.9	8,341	226.0
1810SHBT-60**	18'	5.49	58' 8"	17.89	10,781	305.3	9,096	246.5
1811SHBT-60**	18'	5.49	63' 2"	19.25	11,900	337.0	10,041	272.0
1812SHBT-60**	18'	5.49	65' 10"	20.06	12,571	356.0	10,607	287.4
1814SHBT-60**	18'	5.49	70' 11"	21.62	13,858	392.4	11,693	316.8
2104SHBT-60**	21'	6.40	40' 4"	12.29	7,588	214.9	6,402	173.5
2105SHBT-60**	21'	6.40	43' 11"	13.38	8,806	249.4	7,430	201.3
2106SHBT-60**	21'	6.40	47' 5"	14.46	10,025	283.9	8,458	229.2



SPECIFICATIONS

SILO MODEL NUMBER	DIAMETER (FEET) (METERS)		OVERALL HEIGHT (FEET) (METERS)		VOLUME CAPACITY (CU. FEET) (CU. METERS)		BUSHELs + 5% COMPACTION*	@770 KG/M ³ METRIC TONS
60° HOPPER BOTTOM SILOS - CENTER DISCHARGE - continued								
2107SHBT-60**	21'	6.40	51' 0"	15.55	11,243	318.4	9,486	257.0
2108SHBT-60**	21'	6.40	55' 0"	16.77	12,623	357.5	10,651	288.6
2109SHBT-60**	21'	6.40	58' 7"	15.87	13,842	392.0	11,679	316.4
2110SHBT-60**	21'	6.40	62' 2"	18.94	15,060	426.5	12,707	344.3
2111SHBT-60**	21'	6.40	66' 7"	20.30	16,583	469.6	13,992	379.1
2112SHBT-60**	21'	6.40	69' 3"	21.11	17,497	495.5	14,763	400.0
2114SHBT-60**	21'	6.40	74' 4"	22.67	19,249	545.1	16,241	440.1
45° HOPPER BOTTOM SILOS - CENTER DISCHARGE								
1201HBT	12'	3.66	15' 10"	4.82	744	21.1	598	16.2
1202HBT	12'	3.66	19' 4"	5.90	1,142	32.3	918	24.9
1203HBT	12'	3.66	22' 11"	6.99	1,540	43.6	1,237	33.5
1204HBT	12'	3.66	26' 6"	8.07	1,938	54.9	1,557	42.2
1205HBT	12'	3.66	30' 0"	9.15	2,336	66.1	1,877	50.9
1501HBT	15'	4.57	18' 3"	5.56	1,294	36.6	1,040	28.2
1502HBT	15'	4.57	21' 10"	6.64	1,916	54.3	1,539	41.7
1503HBT	15'	4.57	25' 4"	7.73	2,537	71.9	2,039	55.2
1504HBT	15'	4.57	28' 11"	8.81	3,159	89.5	2,539	68.8
1505HBT	15'	4.57	32' 6"	9.89	3,781	107.1	3,038	82.3
1506HBT	15'	4.57	36' 0"	10.98	4,403	124.7	3,538	95.9
1507SHBT**	15'	4.57	39' 9"	12.11	5,024	142.3	4,239	114.9
1508SHBT**	15'	4.57	43' 4"	13.19	5,646	159.9	4,764	129.1
1509SHBT**	15'	4.57	46' 10"	14.28	6,268	177.5	5,288	143.3
1510SHBT**	15'	4.57	50' 5"	15.36	6,889	195.1	5,813	157.5
1511SHBT**	15'	4.57	54' 10"	16.72	7,667	217.1	6,469	175.3
1804HBT	18'	5.49	31' 5"	9.58	4,741	134.3	4,000	108.4
1805HBT	18'	5.49	35' 0"	10.66	5,636	159.6	4,756	128.9
1806SHBT	18'	5.49	38' 6"	11.75	6,532	185.0	5,511	149.3
1807SHBT**	18'	5.49	42' 1"	12.83	7,427	210.3	6,266	169.8
1808SHBT**	18'	5.49	46' 2"	14.06	8,446	239.2	7,127	193.1
1809SHBT**	18'	5.49	49' 8"	15.15	9,342	264.5	7,882	213.6
1810SHBT**	18'	5.49	53' 3"	16.23	10,237	289.9	8,637	234.0
1811SHBT**	18'	5.49	57' 8"	17.59	11,356	321.6	9,581	259.6
1812SHBT**	18'	5.49	60' 4"	18.40	12,027	340.6	10,148	275.0
1814SHBT**	18'	5.49	65' 6"	19.96	13,314	377.0	11,234	304.4
2104HBT	21'	6.40	33' 9"	10.29	6,714	190.1	5,665	153.5
2105HBT	21'	6.40	37' 4"	11.38	7,933	224.6	6,693	181.4
2106SHBT**	21'	6.40	40' 11"	12.46	9,151	259.1	7,721	209.2
2107SHBT**	21'	6.40	44' 5"	13.55	10,370	293.6	8,749	237.1
2108SHBT**	21'	6.40	48' 6"	14.78	11,758	332.9	9,920	268.8
2109SHBT**	21'	6.40	52' 1"	15.87	12,976	367.5	10,949	296.7
2110SHBT**	21'	6.40	55' 7"	16.95	14,195	402.0	11,977	324.5
2111SHBT**	21'	6.40	60' 1"	18.30	15,718	445.1	13,262	359.3
2112SHBT**	21'	6.40	62' 9"	19.12	16,632	471.0	14,033	380.2
2114SHBT**	21'	6.40	67' 10"	20.67	18,383	520.6	15,511	420.3
2407SHBT**	24'	7.32	47' 5"	14.44	14,144	400.5	11,934	323.3
2408SHBT**	24'	7.32	50' 11"	15.52	15,735	445.6	13,276	359.7
2409SHBT**	24'	7.32	54' 6"	16.61	17,327	490.7	14,619	396.1
2410SHBT**	24'	7.32	58' 1"	17.69	18,918	535.7	15,962	432.5
2411SHBT**	24'	7.32	62' 6"	19.05	20,908	592.1	17,641	478.0
2412SHBT**	24'	7.32	65' 2"	19.86	22,101	625.9	18,648	505.3
2414SHBT**	24'	7.32	70' 3"	21.42	24,389	690.6	20,578	557.6
2707SHBT**	27'	8.23	49' 0"	14.93	18,332	519.1	15,468	419.1
2708SHBT**	27'	8.23	52' 7"	16.02	20,347	576.2	17,167	465.1
2709SHBT**	27'	8.23	56' 1"	17.10	22,361	633.2	18,867	511.2
2710SHBT**	27'	8.23	59' 8"	18.18	24,375	690.3	20,566	557.2
2711SHBT**	27'	8.23	64' 1"	19.54	26,893	761.6	22,691	614.8
2712SHBT**	27'	8.23	66' 9"	20.35	28,404	804.3	23,966	649.3
2714SHBT**	27'	8.23	71' 11"	21.91	31,299	886.3	26,409	715.5
40° STIFFENED HOPPER BOTTOM SILOS - CENTER DISCHARGE								
3007SHBT**	30'	9.14	49' 2"	14.99	22,696	642.7	19,150	518.9
3008SHBT**	30'	9.14	52' 9"	16.07	25,183	713.1	21,248	575.7
3009SHBT**	30'	9.14	56' 4"	17.16	27,670	783.6	23,346	632.6
3010SHBT**	30'	9.14	59' 10"	18.24	30,157	854.0	25,445	689.4
3011SHBT**	30'	9.14	64' 4"	19.60	33,265	942.0	28,067	760.5
3012SHBT**	30'	9.14	67' 0"	20.41	35,130	994.8	29,641	803.1
3014SHBT**	30'	9.14	72' 1"	21.97	38,705	1096.0	32,657	884.8
3307SHBT**	33'	10.06	51' 4"	15.63	28,040	794.0	23,658	641.0
3308SHBT**	33'	10.06	54' 10"	16.72	31,049	879.2	26,197	709.8
3309SHBT**	33'	10.06	58' 5"	17.80	34,058	964.4	28,736	778.6
3310SHBT**	33'	10.06	62' 0"	18.88	37,067	1049.7	31,275	847.4
3311SHBT**	33'	10.06	66' 5"	20.24	40,828	1156.2	34,449	933.4
3312SHBT**	33'	10.06	69' 1"	21.05	43,085	1220.1	36,353	985.0
3314SHBT**	33'	10.06	74' 2"	22.61	47,410	1342.6	40,002	1083.9
3607SHBT**	36'	10.97	53' 5"	16.28	34,057	964.4	28,735	778.6
3608SHBT**	36'	10.97	57' 0"	17.36	37,638	1065.8	31,757	860.4
3609SHBT**	36'	10.97	60' 6"	18.45	41,218	1167.2	34,778	942.3
3610SHBT**	36'	10.97	64' 1"	19.53	44,799	1268.6	37,799	1024.2
3611SHBT**	36'	10.97	68' 6"	20.88	49,276	1395.4	41,576	1126.5
3612SHBT**	36'	10.97	71' 2"	21.70	51,961	1471.4	43,842	1187.9
3614SHBT**	36'	10.97	76' 4"	23.25	57,109	1617.2	48,186	1305.6

* 5% Compaction Applies Only to 1507 SHBT & Above

** One Access Door Provided in Bottom Ring

SCAFCO AERATION & DRYING SYSTEMS

Proper aeration is an important part of every grain storage system and is essential to maintaining grain quality. Properly operated aeration systems help control insect infestation and moisture migration, reducing grain spoilage and saving money.

SCAFCO's aeration systems can be installed in new or existing storage facilities. We use rigid corrugated, perforated aeration ducts made from heavy gauge galvanized steel combined with high efficiency aeration fans.

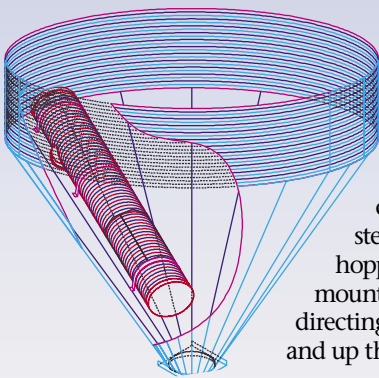

HOPPER BOTTOM SILO AERATION

SCAFCO uses rigid perforated and corrugated galvanized steel pipe for aeration in hopper bottom silos. Fans mount below the hopper, directing air into internal ducts and up through the grain mass.

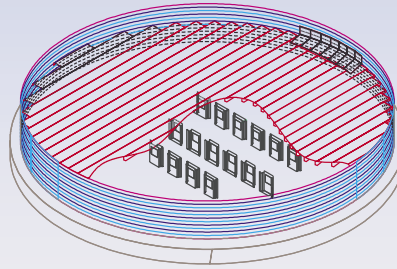

PERFORATED PLANK FLOOR FOR GRAIN DRYING, FAST ERECTION, EASY CLEANING

SCAFCO perforated plank floors ensure fast structure erection, uniform grain drying and easy cleaning. Our interlocking planks are precision roll-formed with 14% perforation and a slight crown for added strength. Planks are supported by heavy-duty legs. Floor design features a complete assembly kit to ensure easy installation.



DOUBLE H-PATTERN

All Double H-pattern Commercial flush floor aeration systems consist of plain and perforated corrugated decking, 4" (100 mm) wide hat-beams, 12" (305 mm) high support legs, ledger angles, perforated strips, corrugated filler strips and fasteners. The plain and perforated corrugated decking are either 18 Gauge (1.17 mm) or 14 Gauge (1.83 mm) thick galvanized steel.



CENTRIFUGAL FANS

SCAFCO has over 100 models of fans, ranging from 50 and 60 Hz, with low and high speed centrifugal and axial configurations. SCAFCO centrifugal fan housings are precision fabricated from heavy gauge galvanized steel which is rust resistant, provides an attractive finish and has a long life. Fan housings are bolted together, using as few pieces as possible to increase the strength and reduce the number of seams that can cause air leakage or wear problems.

FLUSH FLOOR AERATION

SCAFCO Flush Floor systems are easy to install. No preforming is required – simply set our formed steel concrete forms in place and pour the floor! Our system includes 14% open perforated planks with round perforation holes to minimize clogging.



AXIAL FANS

SCAFCO axial fans deliver high capacity airflow at maximum performance. Fans feature all-galvanized steel bodies, heavy-duty cast aluminum blades and energy-efficient electric motors. Available in a variety of fan diameters and horsepower ratings.

ROOF SYSTEMS

All silos 12' (3.66 m) through 42' (12.80 m) diameter are supplied with a single stage self-supporting roof. These roofs are designed for peak equipment load rating of 2000 pounds (907 Kg) and 16 psf (78 kg/sq. m.) live load.

Silos 48' (14.63 m) diameter and larger have two-stage roofs supported by "C" shaped, roll formed galvanized rafters and purlins. These roofs are rated for peak equipment load of 10,000 pounds (4,536 kg) and 25 psf (122 kg/sq. m.) live load. Larger peak equipment loads are available by request. A single stage self-supporting roof is also available for 48' (14.63 m) diameter silos.



rib clips and center clips. Holes in the silo roof and top ring wall sheets are factory-punched for clip installation.

The roofs of 39' (11.89 m) and 42' (12.80 m) diameter silos have a tubular support ring with expandable connectors attached to the exterior of the roof midway between the eave and the segment ring. The support ring provides added strength to the roof structure. These silo roofs are also equipped with 36 roof rib supports.



Center fill opening is 22" (560 mm) diameter for silos 12' (3.66 m) to 24' (7.30 m) diameter. Silos 27' (8.23 m) through 105' (32.00 m) diameter have a 36" (900 mm) diameter fill opening. Optional 60" (1500 mm) opening is also available. All roof pitch is 30°.

Roof panels are triangular sections of galvanized steel with brake-formed raised ribs along each side and 90° formed drip edge at the eave. The roof rib is a box-type rib with 3 1/4" (83 mm) rise. The roof panels are connected to the silo eave with



Each roof assembly 12' (3.66 m) diameter and larger has one panel equipped with factory-installed hinged inspection hatch and a lockable latch. Roof inspection hatch is located at the eave next to the roof ladder. The manhole is trapezoidal-shaped with dimensions 17" x 20" x 24" (430 mm x 508 mm x 610 mm).

Cleats manufactured from galvanized steel are provided for bolting to the roof around the perimeter of the peak cap. Tubular rings are available in lieu of cleats.



SCAFCO ENGINEERED WITH SUPERIOR QUALITY, DESIGN & SAFETY

SCAFCO produces a complete line of storage and handling systems for a variety of applications ranging from small farms to large commercial installations. We offer a wide range of products for cleaning, drying, aeration, conveying and storage needs for grain and other free-flowing bulk commodities. SCAFCO stiffened and non-stiffened silos, hoppers, and accessories are used worldwide.



SCAFCO engineers use the latest in computer drafting and analysis techniques to develop and produce project designs, layouts, shop drawings and manufacturing specifications. Our engineering staff has decades of combined experience in a wide variety of storage, handling and processing applications. A modern computer aided design (CAD) system is used to assure timely, accurate and efficient standard or customized designs.

With SCAFCO, you can be assured that you will receive a superior quality product built to the most strenuous design and safety standards, and have a committed partner standing behind the product to guarantee your satisfaction.

Whether you need a standard or customized solution, contact SCAFCO for engineering, design and production assistance the next time you need silos, handling equipment or accessories!

ADDITIONAL

QUALITY PRODUCTS...



WATER STORAGE TANKS

SCAFCO designs and manufactures water tank systems in 15 different diameters (6' - 36' [1.83 - 10.97 m]) and wall heights up to 14' (4.3 m), with capacities up to 104,000 gallons (394 cu. m).

Our high-quality galvanized steel exteriors get the proven protection of hot-dipped zinc coating. Tanks have a flexible liner made from either PVC (25 mil) or PVC (30 mil). The liner is suspended inside the tank to form a watertight membrane so that stored water never contacts the tank's steel surface. Tank materials and construction ensure that corrosion and maintenance are minimized.

SCAFCO's water tanks benefit from the same superior design features as our other fine storage products, including complete ladder systems, high-strength fasteners, heavy-duty anchor clips, galvanized steel sidewall staves and more. All storage tanks are designed for rapid field assembly.



STEEL FRAMING PRODUCTS

A member of the Steel Stud Manufacturer's Association, SCAFCO produces many quality steel framing products. We supply studs, track, joist and furring materials in a variety of standard and custom shapes and sizes. SCAFCO complies with International Conference of Building Officials standards for product labeling so you can see each product's specifications, such as gauge, decimal thickness and yield strength.

As a manufacturer of steel products for the construction industry since 1954, SCAFCO prides itself on our workmanship and superior customer service.

...ALL BUILT WITH QUALITY MATERIALS

Designed for quick on-site assembly, simplicity of operations, and durability, SCAFCO makes products you can depend on.

SCAFCO designs and manufactures its high-quality products at the company's Spokane, Washington (USA) facility. SCAFCO's 107,500 square feet (10,000 square meters) of plant and office space is outfitted with the most modern engineering and manufacturing technology and equipment available.



A WIDE SELECTION OF SILO SIZES

SPECIFICATIONS

MODEL NUMBER	DIA. (FEET)	DIA. (METERS)	EAVE HEIGHT (FEET)	EAVE HEIGHT (METERS)	OVERALL HEIGHT (FEET)	OVERALL HEIGHT (METERS)	CAPACITY BUSHELS	CAPACITY METRIC TONS WHEAT
1202	12	3.66	7' 3"	2.20	10' 9"	3.29	773	21
1203	12	3.66	10' 9"	3.28	14' 4"	4.37	1,109	30
1204	12	3.66	14' 4"	4.37	17' 11"	5.45	1,445	39
1205	12	3.66	17' 11"	5.45	21' 5"	6.54	1,781	48
1206	12	3.66	21' 5"	6.53	25' 0"	7.62	2,117	58
1207	12	3.66	25' 0"	7.62	28' 7"	8.71	2,453	67
1208	12	3.66	28' 7"	8.70	32' 1"	9.79	2,788	76
1209	12	3.66	32' 1"	9.78	35' 8"	10.87	3,124	85
1210	12	3.66	35' 8"	10.87	39' 8"	11.97	3,460	94
1502	15	4.57	7' 3"	2.20	11' 8"	3.55	1,247	34
1503	15	4.57	10' 9"	3.28	15' 2"	4.63	1,772	48
1504	15	4.57	14' 4"	4.37	18' 9"	5.72	2,297	63
1505	15	4.57	17' 11"	5.45	22' 4"	6.80	2,822	77
1506	15	4.57	21' 5"	6.53	25' 10"	7.88	3,346	91
1507	15	4.57	25' 0"	7.62	29' 5"	8.97	3,871	105
1508	15	4.57	28' 7"	8.70	33' 0"	10.05	4,396	120
1509	15	4.57	32' 1"	9.78	36' 6"	11.14	4,921	134
1510	15	4.57	35' 8"	10.87	40' 1"	12.22	5,445	148
1532S	15	4.57	32' 1"	9.78	36' 6"	11.14	4,921	134
1536S	15	4.57	35' 8"	10.87	40' 1"	12.22	5,445	148
1540S	15	4.57	40' 1"	12.22	44' 6"	13.57	6,101	166
1544S	15	4.57	43' 8"	13.31	48' 1"	14.66	6,626	180
1548S	15	4.57	47' 11"	14.59	52' 4"	15.95	7,249	197
1552S	15	4.57	51' 5"	15.68	55' 10"	17.03	7,774	212
1557S	15	4.57	57' 0"	17.37	61' 5"	18.72	8,594	234
1561S	15	4.57	60' 7"	18.45	65' 0"	19.81	9,119	248
1564S	15	4.57	64' 1"	19.54	68' 6"	20.89	9,643	262
1803	18	5.49	10' 9"	3.28	16' 1"	4.90	2,608	71
1804	18	5.49	14' 4"	4.37	19' 7"	5.98	3,364	92
1805	18	5.49	17' 11"	5.45	23' 2"	7.06	4,119	112
1806	18	5.49	21' 5"	6.53	26' 9"	8.15	4,875	133
1807	18	5.49	25' 0"	7.62	30' 3"	9.23	5,631	153
1808	18	5.49	28' 7"	8.70	33' 10"	10.32	6,386	174
1809	18	5.49	32' 1"	9.78	37' 5"	11.40	7,142	194
1810	18	5.49	35' 8"	10.87	40' 11"	12.48	7,898	215
1832S	18	5.49	32' 1"	9.78	37' 5"	11.40	7,142	194
1836S	18	5.49	35' 8"	10.87	40' 11"	12.48	7,898	215
1840S	18	5.49	40' 1"	12.22	45' 5"	13.84	8,842	241
1844S	18	5.49	43' 8"	13.31	48' 11"	14.92	9,598	261
1848S	18	5.49	47' 11"	14.59	53' 2"	16.21	10,495	286
1852S	18	5.49	51' 5"	15.68	56' 9"	17.29	11,251	306
1857S	18	5.49	57' 0"	17.37	62' 3"	18.98	12,431	338
1861S	18	5.49	60' 7"	18.45	65' 10"	20.07	13,187	359
1864S	18	5.49	64' 1"	19.54	69' 5"	21.15	13,943	379
1868S	18	5.49	67' 8"	20.62	72' 11"	22.24	14,698	400
1871S	18	5.49	71' 3"	21.71	76' 6"	23.32	15,454	421
1875S	18	5.49	74' 9"	22.79	80' 1"	24.40	16,210	441
1878S	18	5.49	78' 4"	23.87	83' 7"	25.49	16,965	462
1881S	18	5.49	81' 11"	24.96	87' 2"	26.57	17,721	482
2104	21	6.40	14' 4"	4.37	20' 6"	6.24	4,655	127
2105	21	6.40	17' 11"	5.45	24' 0"	7.33	5,684	155
2106	21	6.40	21' 5"	6.53	27' 7"	8.41	6,712	183
2107	21	6.40	25' 0"	7.62	31' 2"	9.49	7,741	211
2108	21	6.40	28' 7"	8.70	34' 8"	10.58	8,769	239
2109	21	6.40	32' 1"	9.78	38' 3"	11.66	9,798	267
2110	21	6.40	35' 8"	10.87	41' 10"	12.75	10,826	295
2132S	21	6.40	32' 1"	9.78	38' 3"	11.66	9,798	267
2136S	21	6.40	35' 8"	10.87	41' 10"	12.75	10,826	295
2140S	21	6.40	40' 1"	12.22	46' 3"	14.10	12,112	330
2144S	21	6.40	43' 8"	13.31	49' 10"	15.18	13,140	358
2148S	21	6.40	47' 11"	14.59	54' 0"	16.47	14,361	391
2152S	21	6.40	51' 5"	15.68	57' 7"	17.55	15,390	419
2157S	21	6.40	57' 0"	17.37	63' 2"	19.25	16,997	463
2161S	21	6.40	60' 7"	18.45	66' 8"	20.33	18,026	491
2164S	21	6.40	64' 1"	19.54	70' 3"	21.41	19,054	519
2168S	21	6.40	67' 8"	20.62	73' 10"	22.50	20,083	547
2171S	21	6.40	71' 3"	21.71	77' 4"	23.58	21,111	575
2175S	21	6.40	74' 9"	22.79	80' 11"	24.67	22,140	603
2178S	21	6.40	78' 4"	23.87	84' 6"	25.75	23,168	631
2181S	21	6.40	81' 11"	24.96	88' 0"	26.83	24,197	659
2404	24	7.32	14' 4"	4.37	21' 4"	6.51	6,209	169
2405	24	7.32	17' 11"	5.45	24' 11"	7.59	7,559	206
2406	24	7.32	21' 5"	6.53	28' 5"	8.67	8,909	242
2407	24	7.32	25' 0"	7.62	32' 0"	9.76	10,259	279
2408	24	7.32	28' 7"	8.70	35' 7"	10.84	11,608	316
2409	24	7.32	32' 1"	9.78	39' 1"	11.92	12,958	353
2410	24	7.32	35' 8"	10.87	42' 8"	13.01	14,308	389
2432S	24	7.32	32' 1"	9.78	39' 1"	11.92	12,958	353
2436S	24	7.32	35' 8"	10.87	42' 8"	13.01	14,308	389
2440S	24	7.32	40' 1"	12.22	47' 1"	14.36	15,995	435
2444S	24	7.32	43' 8"	13.31	50' 8"	15.45	17,345	472
2448S	24	7.32	47' 11"	14.59	54' 11"	16.73	18,948	516
2452S	24	7.32	51' 5"	15.68	58' 5"	17.82	20,297	552
2457S	24	7.32	57' 0"	17.37	64' 0"	19.51	22,406	610
2461S	24	7.32	60' 7"	18.45	67' 7"	20.59	23,756	647

SPECIFICATIONS

MODEL NUMBER	DIA. (FEET)	DIA. (METERS)	EAVE HEIGHT (FEET)	EAVE HEIGHT (METERS)	OVERALL HEIGHT (FEET)	OVERALL HEIGHT (METERS)	CAPACITY BUSHELS	CAPACITY METRIC TONS WHEAT
2464S	24	7.32	64' 1"	19.54	71' 1"	21.68	25,106	683
2468S	24	7.32	67' 8"	20.62	74' 8"	22.76	26,456	720
2471S	24	7.32	71' 3"	21.71	78' 3"	23.84	27,805	757
2475S	24	7.32	74' 9"	22.79	81' 9"	24.93	29,155	793
2478S	24	7.32	78' 4"	23.87	85' 4"	26.01	30,505	830
2481S	24	7.32	81' 11"	24.96	88' 11"	27.10	31,855	867
2705	27	8.23	17' 11"	5.45	25' 2"	7.68	9,740	265
2706	27	8.23	21' 5"	6.53	28' 9"	8.76	11,456	312
2707	27	8.23	25' 0"	7.62	32' 4"	9.84	13,173	359
2708	27	8.23	28' 7"	8.70	35' 10"	10.93	14,889	405
2709	27	8.23	32' 1"	9.78	39' 5"	12.01	16,605	452
2710	27	8.23	35' 8"	10.87	43' 0"	13.10	18,322	499
2732S	27	8.23	32' 1"	9.78	39' 5"	12.01	16,605	452
2736S	27	8.23	35' 8"	10.87	43' 0"	13.10	18,322	499
2740S	27	8.23	40' 1"	12.22	47' 5"	14.45	20,467	557
2744S	27	8.23	43' 8"	13.31	51' 0"	15.53	22,184	604
2748S	27	8.23	47' 11"	14.59	55' 2"	16.82	24,222	659
2752S	27	8.23	51' 5"	15.68	58' 9"	17.90	25,938	706
2757S	27	8.23	57' 0"	17.37	64' 4"	19.60	28,620	779
2761S	27	8.23	60' 7"	18.45	67' 10"	20.68	30,336	826
2764S	27	8.23	64' 1"	19.54	71' 5"	21.77	32,053	872
2768S	27	8.23	67' 8"	20.62	75' 0"	22.85	33,769	919
2771S	27	8.23	71' 3"	21.71	78' 6"	23.93	35,486	966
2775S	27	8.23	74' 9"	22.79	82' 1"	25.02	37,202	1,012
2778S	27	8.23	78' 4"	23.87	85' 8"	26.10	38,918	1,059
2781S	27	8.23	81' 11"	24.96	89' 2"	27.18	40,635	1,106
3005	30	9.14	17' 11"	5.45	26' 1"	7.94	12,240	333
3006	30	9.14	21' 5"	6.53	29' 7"	9.02	14,369	391
3007	30	9.14	25' 0"	7.62	33' 2"	10.11	16,498	449
3008	30	9.14	28' 7"	8.70	36' 9"	11.19	18,627	507
3009	30	9.14	32' 1"	9.78	40' 3"	12.27	20,756	565
3010	30	9.14	35' 8"	10.87	43' 10"	13.36	22,885	623
3032S	30	9.14	32' 1"	9.78	40' 3"	12.27	20,756	565
3036S	30	9.14	35' 8"	10.87	43' 10"	13.36	22,885	623
3040S	30	9.14	40' 1"	12.22	48' 3"	14.71	25,546	695
3044S	30	9.14	43' 8"	13.31	51' 10"	15.80	27,675	753
3048S	30	9.14	47' 11"	14.59	56' 1"	17.08	30,203	822
3052S	30	9.14	51' 5"	15.68	59' 7"	18.17	32,332	880
3057S	30	9.14	57' 0"	17.37	65' 2"	19.86	35,658	970
3061S	30	9.14	60' 7"	18.45	68' 9"	20.94	37,787	1,028
3064S	30	9.14	64' 1"	19.54	72' 3"	22.03	39,916	1,086
3068S	30	9.14	67' 8"	20.62	75' 10"	23.11	42,045	1,144
3071S	30	9.14	71' 3"	21.71	79' 5"	24.20	44,174	1,202
3075S	30	9.14	74' 9"	22.79	82' 11"	25.28	46,303	1,260
3078S	30	9.14	78' 4"	23.87	86' 6"	26.36	48,432	1,318
3081S	30	9.14	81' 11"	24.96	90' 1"	27.45	50,561	1,376
3305	33	10.06	17' 11"	5.45	26' 11"	8.20	15,002	408
3306	33	10.06	21' 5"	6.53	30' 6"	9.29	17,578	478
3307	33	10.06	25' 0"	7.62	34' 0"	10.37	20,154	549
3308	33	10.06	28' 7"	8.70	37' 7"	11.45	22,730	619
3309	33	10.06	32' 1"	9.78	41' 2"	12.54	25,306	689
3310	33	10.06	35' 8"	10.87	44' 8"	13.62	27,882	759
3332S	33	10.06	32' 1"	9.78	41' 2"	12.54	25,306	689
3336S	33	10.06	35' 8"	10.87	44' 8"	13.62	27,882	759
3340S	33	10.06	40' 1"	12.22	49' 2"	14.98	31,102	846
3344S	33	10.06	43' 8"	13.31	52' 8"	16.06	33,678	917
3348S	33	10.06	47' 11"	14.59	56' 11"	17.35	36,737	1,000
3352S	33	10.06	51' 5"	15.68	60' 6"	18.43	39,313	1,070
3357S	33	10.06	57' 0"	17.37	66' 0"	20.12	43,338	1,179
3361S	33	10.06	60' 7"	18.45	69' 7"	21.21	45,914	1,250
3364S	33	10.06	64' 1"	19.54	73' 2"	22.29	48,490	1,320
3368S	33	10.06	67' 8"	20.62	76' 8"	23.37	51,066	1,390
3371S	33	10.06	71' 3"	21.71	80' 3"	24.46	53,642	1,460
3375S	33	10.06	74' 9"	22.79	83' 10"	25.54	56,219	1,530
3378S	33	10.06	78' 4"	23.87	87' 4"	26.63	58,795	1,600
3381S	33	10.06	81' 11"	24.96	90' 11"	27.71	61,371	1,670
3385S	33	10.06	85' 5"	26.04	94' 6"	28.79	63,947	1,740
3605	36	10.97	17' 11"	5.45	27' 9"	8.46	18,166	494
3606	36	10.97	21' 5"	6.53	31' 4"	9.55	21,246	578
3607	36	10.97	25' 0"	7.62	34' 11"	10.63	24,326	662
3608	36	10.97	28' 7"	8.70	38' 5"	11.72	27,406	746
3609	36	10.97	32' 1"	9.78	42' 0"	12.80	30,487	830
3610	36	10.97	35' 8"	10.87	45' 7"	13.88	33,567	914
3632S	36	10.97	32' 1"	9.78	42' 0"	12.80	30,487	830
3636S	36	10.97	35' 8"	10.87	45' 7"	13.88	33,567	914
3640S	36	10.97	40' 1"	12.22	50' 0"	15.24	37,417	1,018
3644S	36	10.97	43' 8"	13.31	53' 7"	16.32	40,497	1,102
3648S	36	10.97	47' 11"	14.59	57' 9"	17.61	44,155	1,202
3652S	36	10.97	51' 5"	15.68	61' 4"	18.69	47,235	1,286
3657S	36	10.97	57' 0"	17.37	66' 11"	20.39	52,047	1,417
3661S	36	10.97	60' 7"	18.45	70' 5"	21.47	55,127	1,500
3664S	36	10.97	64' 1"	19.54	74' 0"	22.55	58,208	1,584
3668S	36	10.97	67' 8"	20.62	77' 7"	23.64	61,288	1,668
3671S	36	10.97	71' 3"	21.71	81' 1"	24.72	64,368	1,752
3675S	36	10.97	74' 9"	22.79	84' 8"	25.80	67,448	1,836

SPECIFICATIONS

MODEL NUMBER	DIA. (FEET)	DIA. (METERS)	EAVE HEIGHT (FEET)	EAVE HEIGHT (METERS)	OVERALL HEIGHT (FEET)	OVERALL HEIGHT (METERS)	CAPACITY BUSHELS	CAPACITY METRIC TONS WHEAT
3678S	36	10.97	78' 4"	23.87	88' 3"	26.89	70,528	1,919
3681S	36	10.97	81' 11"	24.96	91' 9"	27.97	73,608	2,003
3685S	36	10.97	85' 5"	26.04	95' 4"	29.05	76,688	2,087
3905	39	11.89	17' 11"	5.45	28' 8"	8.73	21,589	588
3906	39	11.89	21' 5"	6.53	32' 2"	9.81	25,204	686
3907	39	11.89	25' 0"	7.62	35' 9"	10.89	28,819	784
3908	39	11.89	28' 7"	8.70	39' 4"	11.98	32,433	883
3909	39	11.89	32' 1"	9.78	42' 10"	13.06	36,048	981
3932S	39	11.89	32' 1"	9.78	42' 10"	13.06	36,048	981
3936S	39	11.89	35' 8"	10.87	46' 5"	14.15	39,663	1,079
3940S	39	11.89	40' 1"	12.22	50' 10"	15.50	44,182	1,202
3944S	39	11.89	43' 8"	13.31	54' 5"	16.58	47,797	1,301
3948S	39	11.89	47' 11"	14.59	58' 8"	17.87	52,089	1,418
3952S	39	11.89	51' 5"	15.68	62' 2"	18.95	55,704	1,516
3957S	39	11.89	57' 0"	17.37	67' 9"	20.65	61,352	1,670
3961S	39	11.89	60' 7"	18.45	71' 4"	21.73	64,967	1,768
3964S	39	11.89	64' 1"	19.54	74' 10"	22.82	68,582	1,867
3968S	39	11.89	67' 8"	20.62	78' 5"	23.90	72,197	1,965
3971S	39	11.89	71' 3"	21.71	82' 0"	24.98	75,812	2,063
3975S	39	11.89	74' 9"	22.79	85' 6"	26.07	79,426	2,162
3978S	39	11.89	78' 4"	23.87	89' 1"	27.15	83,041	2,260
3981S	39	11.89	81' 11"	24.96	92' 8"	28.23	86,656	2,358
3985S	39	11.89	85' 5"	26.04	96' 2"	29.32	90,271	2,457
4205	42	12.80	17' 11"	5.45	29' 6"	8.99	25,350	690
4206	42	12.80	21' 5"	6.53	33' 1"	10.07	29,542	804
4207	42	12.80	25' 0"	7.62	36' 7"	11.16	33,735	918
4208	42	12.80	28' 7"	8.70	40' 2"	12.24	37,927	1,032
4209	42	12.80	32' 1"	9.78	43' 9"	13.32	42,119	1,146
4232S	42	12.80	32' 1"	9.78	43' 9"	13.32	42,119	1,146
4236S	42	12.80	35' 8"	10.87	47' 3"	14.41	46,312	1,260
4240S	42	12.80	40' 1"	12.22	51' 9"	15.76	51,552	1,403
4244S	42	12.80	43' 8"	13.31	55' 3"	16.85	55,744	1,517
4248S	42	12.80	47' 11"	14.59	59' 6"	18.13	60,723	1,653
4252S	42	12.80	51' 5"	15.68	63' 1"	19.22	64,915	1,767
4257S	42	12.80	57' 0"	17.37	68' 7"	20.91	71,466	1,945
4261S	42	12.80	60' 7"	18.45	72' 2"	21.99	75,658	2,059
4264S	42	12.80	64' 1"	19.54	75' 9"	23.08	79,851	2,173
4268S	42	12.80	67' 8"	20.62	79' 3"	24.16	84,043	2,287
4271S	42	12.80	71' 3"	21.71	82' 10"	25.25	88,235	2,401
4275S	42	12.80	74' 9"	22.79	86' 5"	26.33	92,428	2,515
4278S	42	12.80	78' 4"	23.87	89' 1"	27.41	96,620	2,630
4281S	42	12.80	81' 11"	24.96	93' 6"	28.50	100,812	2,744
4285S	42	12.80	85' 5"	26.04	97' 1"	29.58	105,005	2,858
4805	48	14.63	17' 11"	5.45	31' 6"	9.61	33,924	923
4806	48	14.63	21' 5"	6.53	35' 1"	10.69	39,400	1,072
4807	48	14.63	25' 0"	7.62	38' 8"	11.78	44,876	1,221
4808	48	14.63	28' 7"	8.70	42' 2"	12.86	50,352	1,370
4809	48	14.63	32' 1"	9.78	45' 9"	13.95	55,827	1,519
4832S	48	14.63	32' 1"	9.78	45' 9"	13.95	55,827	1,519
4836S	48	14.63	35' 8"	10.87	49' 4"	15.03	61,303	1,668
4840S	48	14.63	40' 1"	12.22	53' 9"	16.38	68,148	1,855
4844S	48	14.63	43' 8"	13.31	57' 4"	17.47	73,624	2,004
4848S	48	14.63	47' 11"	14.59	61' 6"	18.76	80,126	2,181
4852S	48	14.63	51' 5"	15.68	65' 1"	19.84	85,602	2,330
4857S	48	14.63	57' 0"	17.37	70' 8"	21.53	94,158	2,563
4861S	48	14.63	60' 7"	18.45	74' 2"	22.62	99,633	2,712
4864S	48	14.63	64' 1"	19.54	77' 9"	23.70	105,109	2,861
4868S	48	14.63	67' 8"	20.62	81' 4"	24.78	110,585	3,010
4871S	48	14.63	71' 3"	21.71	84' 10"	25.87	116,061	3,159
4875S	48	14.63	74' 9"	22.79	88' 5"	26.95	121,536	3,308
4878S	48	14.63	78' 4"	23.87	92' 0"	28.03	127,012	3,457
4881S	48	14.63	81' 11"	24.96	95' 6"	29.12	132,488	3,606
4885S	48	14.63	85' 5"	26.04	99' 1"	30.20	137,964	3,755
5432S	54	16.46	32' 1"	9.78	47' 6"	14.47	71,688	1,951
5436S	54	16.46	35' 8"	10.87	51' 0"	15.56	78,618	2,140
5440S	54	16.46	40' 1"	12.22	55' 6"	16.91	87,281	2,375
5444S	54	16.46	43' 8"	13.31	59' 0"	17.99	94,211	2,564
5448S	54	16.46	48' 1"	14.66	63' 6"	19.35	102,874	2,800
5452S	54	16.46	51' 8"	15.75	67' 0"	20.43	109,804	2,988
5457S	54	16.46	57' 0"	17.37	72' 4"	22.06	120,199	3,271
5461S	54	16.46	60' 7"	18.45	75' 11"	23.14	127,129	3,460
5464S	54	16.46	64' 1"	19.54	79' 6"	24.22	134,060	3,649
5468S	54	16.46	67' 8"	20.62	83' 0"	25.31	140,990	3,837
5471S	54	16.46	71' 3"	21.71	86' 7"	26.39	147,920	4,026
5475S	54	16.46	74' 9"	22.79	90' 2"	27.48	154,850	4,214
5478S	54	16.46	78' 4"	23.87	93' 8"	28.56	161,781	4,403
5481S	54	16.46	81' 11"	24.96	97' 3"	29.64	168,711	4,592
5485S	54	16.46	85' 5"	26.04	100' 10"	30.73	175,641	4,780
6021S	60	18.29	21' 5"	6.53	38' 6"	11.75	64,108	1,745
6025S	60	18.29	25' 0"	7.62	42' 1"	12.83	72,664	1,978
6032S	60	18.29	32' 1"	9.78	49' 2"	15.00	89,776	2,443
6036S	60	18.29	35' 8"	10.87	52' 9"	16.08	98,332	2,676
6040S	60	18.29	40' 1"	12.22	57' 2"	17.43	109,026	2,967
6044S	60	18.29	43' 8"	13.31	60' 9"	18.52	117,582	3,200
6048S	60	18.29	48' 1"	14.66	65' 2"	19.87	128,277	3,491
6052S	60	18.29	51' 8"	15.75	68' 9"	20.96	136,833	3,724

SPECIFICATIONS

MODEL NUMBER	DIA. (FEET)	DIA. (METERS)	EAVE HEIGHT (FEET)	EAVE HEIGHT (METERS)	OVERALL HEIGHT (FEET)	OVERALL HEIGHT (METERS)	CAPACITY BUSHEL	CAPACITY METRIC TONS WHEAT
6057S	60	18.29	57' 0"	17.37	74' 1"	22.58	149,667	4,073
6061S	60	18.29	60' 7"	18.45	77' 8"	23.67	158,223	4,306
6064S	60	18.29	64' 1"	19.54	81' 2"	24.75	166,779	4,539
6068S	60	18.29	67' 8"	20.62	84' 9"	25.83	175,334	4,772
6071S	60	18.29	71' 3"	21.71	88' 4"	26.92	183,890	5,005
6075S	60	18.29	74' 9"	22.79	91' 10"	28.00	192,446	5,238
6078S	60	18.29	78' 4"	23.87	95' 5"	29.09	201,002	5,470
6081S	60	18.29	81' 11"	24.96	99' 0"	30.17	209,558	5,703
6085S	60	18.29	85' 5"	26.04	102' 7"	31.25	218,114	5,936
7232S	72	21.95	32' 1"	9.78	52' 8"	16.05	132,943	3,618
7236S	72	21.95	35' 8"	10.87	56' 2"	17.13	145,263	3,953
7240S	72	21.95	40' 1"	12.22	60' 8"	18.49	160,664	4,373
7244S	72	21.95	43' 8"	13.31	64' 2"	19.57	172,984	4,708
7248S	72	21.95	48' 1"	14.66	68' 8"	20.92	188,385	5,127
7252S	72	21.95	51' 8"	15.75	72' 2"	22.01	200,705	5,462
7257S	72	21.95	57' 0"	17.37	77' 6"	23.63	219,186	5,965
7261S	72	21.95	60' 7"	18.45	81' 1"	24.72	231,506	6,301
7264S	72	21.95	64' 1"	19.54	84' 8"	25.80	243,826	6,636
7268S	72	21.95	67' 8"	20.62	88' 2"	26.88	256,147	6,971
7271S	72	21.95	71' 3"	21.71	91' 9"	27.97	268,467	7,307
7275S	72	21.95	74' 9"	22.79	95' 4"	29.05	280,788	7,642
7278S	72	21.95	78' 4"	23.87	98' 10"	30.14	293,108	7,977
7281S	72	21.95	81' 11"	24.96	102' 5"	31.22	305,429	8,312
7285S	72	21.95	85' 5"	26.04	105' 0"	32.30	317,749	8,648
7532S	75	22.86	32' 1"	9.78	53' 6"	16.31	145,246	3,953
7536S	75	22.86	35' 8"	10.87	57' 1"	17.39	158,615	4,317
7540S	75	22.86	40' 1"	12.22	61' 6"	18.75	175,325	4,772
7544S	75	22.86	43' 8"	13.31	65' 1"	19.83	188,694	5,135
7548S	75	22.86	48' 1"	14.66	69' 6"	21.19	205,405	5,590
7552S	75	22.86	51' 8"	15.75	73' 1"	22.27	218,773	5,954
7557S	75	22.86	57' 0"	17.37	78' 5"	23.90	238,826	6,500
7561S	75	22.86	60' 7"	18.45	81' 11"	24.98	252,194	6,864
7564S	75	22.86	64' 1"	19.54	85' 6"	26.06	265,563	7,228
7568S	75	22.86	67' 8"	20.62	89' 1"	27.15	278,932	7,591
7571S	75	22.86	71' 3"	21.71	92' 7"	28.23	292,300	7,955
7575S	75	22.86	74' 9"	22.79	96' 2"	29.31	305,669	8,319
7578S	75	22.86	78' 4"	23.87	99' 9"	30.40	319,037	8,683
7581S	75	22.86	81' 11"	24.96	103' 3"	31.48	332,406	9,047
7585S	75	22.86	85' 5"	26.04	106' 10"	32.57	345,744	9,411
7832S	78	23.77	32' 1"	9.78	54' 4"	16.57	158,174	4,305
7836S	78	23.77	35' 8"	10.87	57' 11"	17.66	172,633	4,698
7840S	78	23.77	40' 1"	12.22	62' 4"	19.01	190,707	5,190
7844S	78	23.77	43' 8"	13.31	65' 1"	20.09	205,167	5,584
7848S	78	23.77	48' 1"	14.66	70' 4"	21.45	223,241	6,076
7852S	78	23.77	51' 8"	15.75	73' 11"	22.53	237,700	6,469
7857S	78	23.77	57' 0"	17.37	79' 3"	24.16	259,390	7,060
7861S	78	23.77	60' 7"	18.45	82' 10"	25.24	273,849	7,453
7864S	78	23.77	64' 1"	19.54	86' 4"	26.33	288,308	7,847
7868S	78	23.77	67' 8"	20.62	89' 11"	27.41	302,768	8,240
7871S	78	23.77	71' 3"	21.71	93' 6"	28.49	317,227	8,634
7875S	78	23.77	74' 9"	22.79	97' 0"	29.58	331,687	9,027
7878S	78	23.77	78' 4"	23.87	100' 7"	30.66	346,146	9,421
7881S	78	23.77	81' 11"	24.96	104' 2"	31.74	360,605	9,814
7885S	78	23.77	85' 5"	26.04	107' 9"	32.83	325,065	10,208
9032S	90	27.43	32' 1"	9.78	57' 10"	17.62	216,314	5,887
9036S	90	27.43	35' 8"	10.87	61' 4"	18.71	235,564	6,411
9040S	90	27.43	40' 1"	12.22	65' 10"	20.06	259,628	7,066
9044S	90	27.43	43' 8"	13.31	69' 4"	21.14	278,878	7,590
9048S	90	27.43	48' 1"	14.66	73' 10"	22.50	302,942	8,245
9052S	90	27.43	51' 8"	15.75	77' 4"	23.58	322,192	8,769
9057S	90	27.43	57' 0"	17.37	82' 8"	25.21	351,068	9,555
9061S	90	27.43	60' 7"	18.45	86' 3"	26.29	370,319	10,079
9064S	90	27.43	64' 1"	19.54	89' 10"	27.38	389,570	10,602
9068S	90	27.43	67' 8"	20.62	93' 4"	28.46	408,820	11,126
9071S	90	27.43	71' 3"	21.71	96' 11"	29.54	428,071	11,650
9075S	90	27.43	74' 9"	22.79	100' 6"	30.63	447,322	12,174
9078S	90	27.43	78' 4"	23.87	104' 0"	31.71	466,572	12,698
9081S	90	27.43	81' 11"	24.96	107' 7"	32.79	485,823	13,222
9085S	90	27.43	85' 5"	26.04	111' 2"	33.88	505,074	13,746
10532S	105	32.00	32' 1"	9.78	62' 1"	18.94	304,171	8,278
10536S	105	32.00	35' 8"	10.87	65' 8"	20.02	330,373	8,991
10540S	105	32.00	40' 1"	12.22	70' 1"	21.37	363,126	9,883
10544S	105	32.00	43' 8"	13.31	73' 8"	22.46	389,329	10,596
10548S	105	32.00	48' 1"	14.66	78' 1"	23.81	422,081	11,487
10552S	105	32.00	51' 8"	15.75	81' 8"	24.90	448,284	12,200
10557S	105	32.00	57' 0"	17.37	87' 0"	26.52	487,587	13,270
10561S	105	32.00	60' 7"	18.45	90' 7"	27.60	513,790	13,983
10564S	105	32.00	64' 1"	19.54	94' 1"	28.69	539,992	14,696
10568S	105	32.00	67' 8"	20.62	97' 8"	29.77	566,194	15,409
10571S	105	32.00	71' 3"	21.71	101' 3"	30.86	592,396	16,123
10575S	105	32.00	74' 9"	22.79	104' 9"	31.94	618,599	16,836
10578S	105	32.00	78' 4"	23.87	108' 4"	33.02	644,801	17,549
10581S	105	32.00	81' 11"	24.96	111' 11"	34.11	671,003	18,262
10585S	105	32.00	85' 5"	26.04	115' 6"	35.19	697,206	18,975



SCAFCO
GRAIN SYSTEMS, LLC

5400 East Broadway Avenue
P.O. Box 11215
Spokane, Washington 99211-1215, USA
Toll Free (800) 224-0676
Telephone (509) 535-1571
Fax: (509) 535-9130
Email: mail@SCAFCO.com
Web: www.SCAFCO.com